

**PUBLIC RIGHTS OF WAY AFFECTED BY DEVELOPMENT
SECTION 257 TOWN & COUNTRY PLANNING ACT 1990
FOOTPATHS 30 HEYBRIDGE & 3 LANGFORD**

Plan No. PROW-23-38 06Dec2023

Routes to close: A-B, E-H-F-G _____

New routes: A-C-D-B, H-C - - - - -

Unaffected routes: 3

Postcode at Point E: CM9 4SP

Grid Ref at Point E: 58446,20865

Definitive Map Sheet: TL80NW. Map Scale 1:1,750

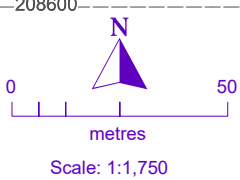
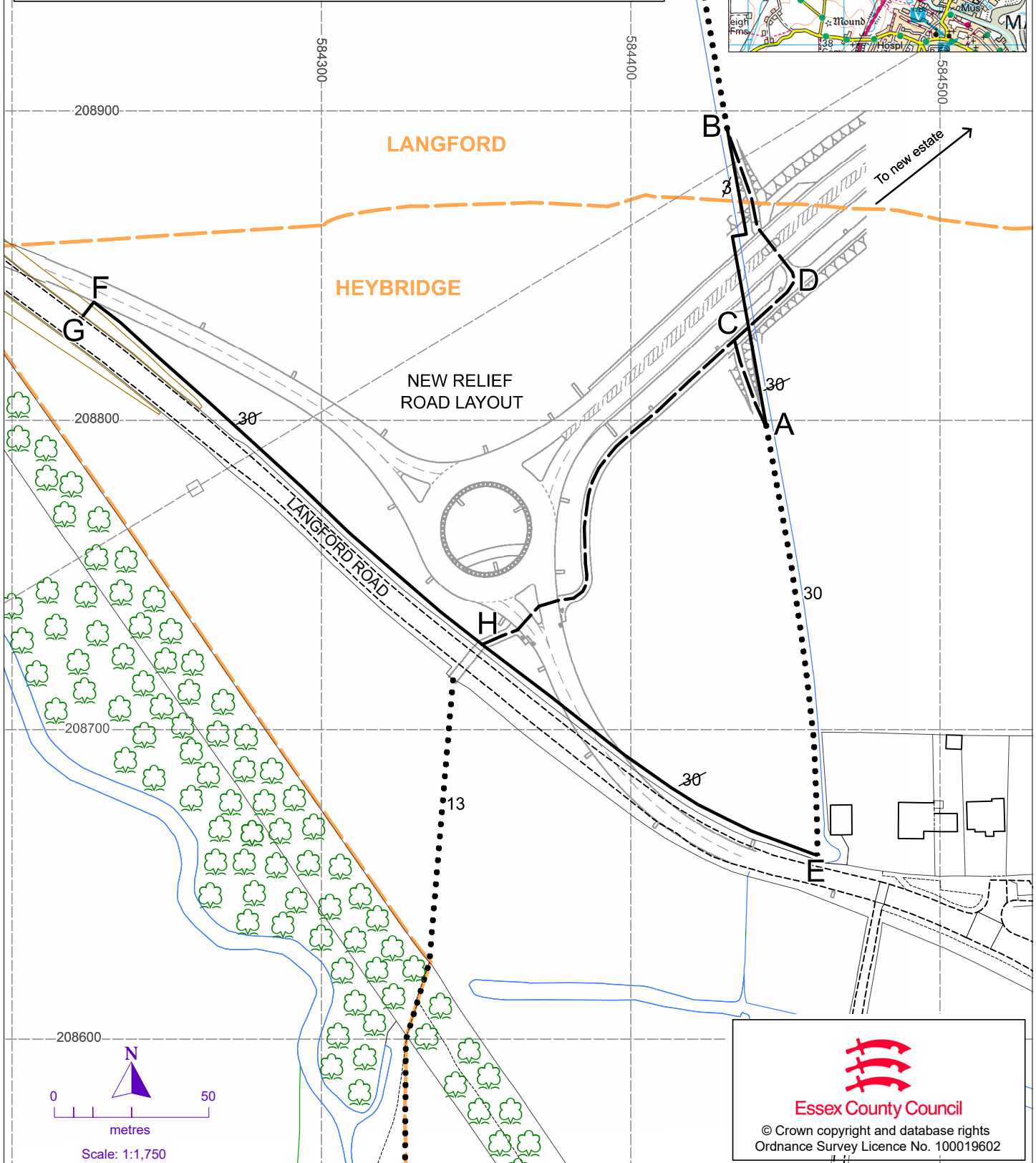
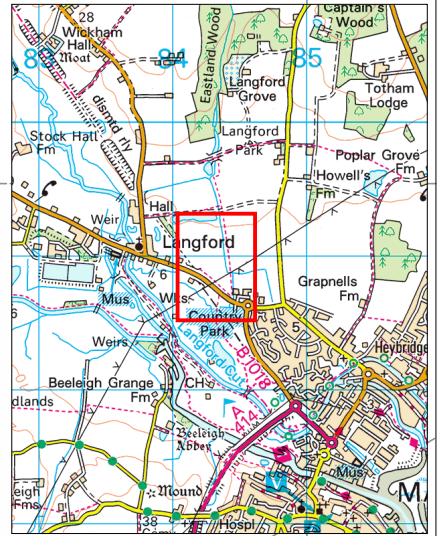

Essex County Council
© Crown copyright and database rights
Ordnance Survey Licence No. 100019602